

SURFACE MANIFOLD CABINETS SUBMITTAL



Project Name _____ Date _____

Submitted By _____ Phone _____

Project Location _____

Engineer _____ Contractor _____

Approval _____ P.O. Number _____

Surface mounted cabinet manifolds

Surface manifold cabinets allows for a neat and professional installation in areas where the manifold might otherwise be visible or subject to damage. Cabinets are made from hot-dipped 20 Gauge galvanized steel. To save on space and to reduce damage during shipping, cabinets come boxed flat and un-assembled. Also featuring; a durable white finish, door with latch, adjustable manifold mounting brackets Inside the cabinet, and a removable door and lower section for easy access during installation.

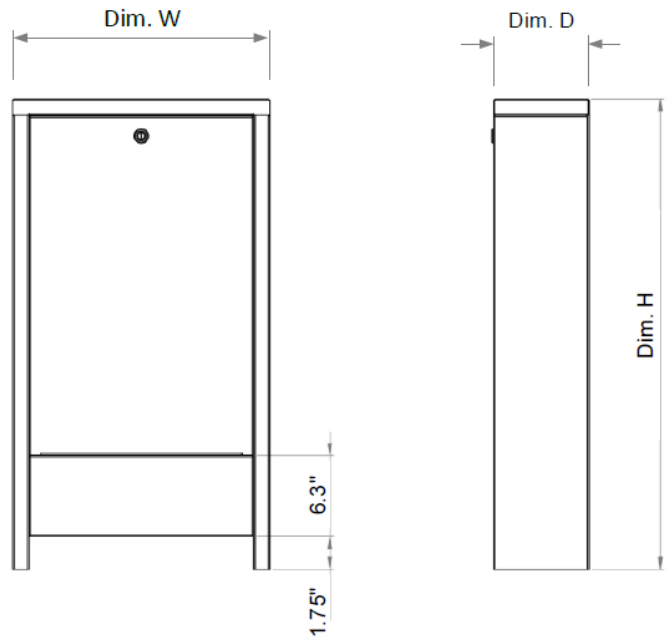

Manifold Cabinets

Part #	Description	Type	Unit
12421	Manifold Cabinet, Un-assembled, W20.8", H27.2", D4.3"-6.3"	Surface	Each
12431	Manifold Cabinet, Un-assembled, W26.8", H27.2", D4.3"-6.3"	Surface	Each
12451	Manifold Cabinet, Un-assembled, W40.5", H27.2", D4.3"-6.3"	Surface	Each

Manifold Cabinet Selection Chart

Part #	1" Stainless	1" Stainless	1 1/4" Stainless	1 1/4" Stainless
	No Ball Valve	With Ball Valve	No Ball Valve	With Ball Valve
12421	Up to 7 loops	Up to 6 Loops	Up to 7Loops	Up to 6 Loops
12431	Up to 11 Loops	Up to 10 Loops	Up to11 Loops	Up to 10 Loops
12451	UP to 12 Loops	Up to 12 Loops	Up to 12 Loops	Up to 12 Loops